

ILL. No.	Part No.	Description	Qty. Rqd.
----------	----------	-------------	-----------

ENGINE ELECTRICS

REMARKS LEGEND -

Engine (e) numbers:

35D = 3.9 liter, manual transmission, distributor ignition

36D = 3.9 liter, automatic transmission, distributor ignition

50D = 4.0 liter, electronic ignition

Vehicle i.d. (v) numbers:

SA = 1995 model year

MONEY-SAVING KITS NOTED IN RED TYPE

Engine Sensors

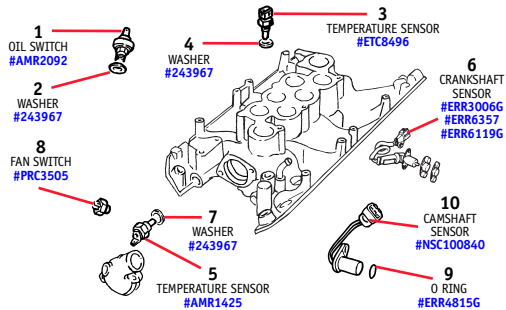

- | | | | |
|----|-----------|--|---|
| 1 | AMR2092 | SWITCH, oil pressure | 1 |
| 2 | 243967 | WASHER, sealing | 1 |
| 3 | ETC8496 | SENSOR, engine coolant temperature, to control unit | 1 |
| 4 | 243967 | WASHER, sealing | 1 |
| 5 | AMR1425 | SENSOR, engine coolant temperature, to gauge | 1 |
| 6 | ERR30066 | SENSOR, crankshaft, manual, w/GEMS, Genuine | 1 |
| | ERR6357 | Through (e) 50D09963A | |
| | ERR6119G | SENSOR, crankshaft, manual, w/GEMS | 1 |
| | | From (e) 50D09964A | |
| | ERR6119G | SENSOR, crankshaft, automatic w/GEMS, Genuine | 1 |
| 7 | 243967 | WASHER, sealing | 1 |
| 8 | PRC3505 | SWITCH, fan, temperature | 1 |
| 9 | ERR4815G | O RING, camshaft sensor, Genuine (e) 50D engines | 1 |
| 10 | NSC100840 | CAMSHAFT SENSOR, Genuine | 1 |
| 11 | ERR3799 | SPARK PLUG, Champion RN 11YC4 | 8 |
| | ETC6437 | SPARK PLUG, Champion RN 12 YC Alternative to ERR3799 | 8 |

H.T. Leads and Spark Plugs

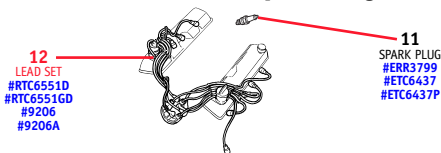

- | | | | |
|-----------|----------|----------|------------|
| 12 | LEAD SET | 11 | SPARK PLUG |
| #RTC6551D | #ERR3799 | #ETC6437 | #ETC6437P |
| #9206 | | | |
| #9206A | | | |

ILL. No.	Part No.	Description	Qty. Rqd.
----------	----------	-------------	-----------



13
COIL LEAD
#STC9124
#STC9124G

- | | | | |
|----|-----------|--|---|
| | ETC6437P | SPARK PLUG, Bosch Platinum Alternative to ERR3799 | 8 |
| 12 | RTC6551D | LEAD SET, high tension (e) 35D, 36D engines | 1 |
| | RTC6551GD | LEAD SET, high tension, Genuine (e) 35D, 36D engines | 1 |
| | 9206 | LEAD SET, high tension, Genuine (e) 50D engines | 1 |
| | 9206A | LEAD SET, high tension (e) 50D engines | 1 |
| 13 | STC9124 | COIL LEAD, with cover (e) 35D, 36D engines | 1 |
| | STC9124G | COIL LEAD, with cover, Genuine (e) 35D, 36D engines | 1 |

Distributor

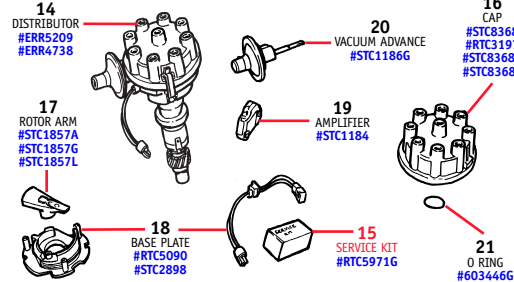

- | | | | |
|----|----------|---|---|
| 14 | ERR5209 | DISTRIBUTOR ASSEMBLY From (e) 35D09450B and 36D28464B; as shown no module on distributor. Not (e) 50D | 1 |
| | ERR4738 | DISTRIBUTOR ASSEMBLY, Genuine May be used to replace ERR4755 with module on distributor | 1 |
| 15 | RTC5971G | SERVICE KIT, distributor, Genuine Includes all screws, seals and retainers for distributor | 1 |
| 16 | STC8368 | CAP, distributor | 1 |
| | RTC3197 | CAP, distributor Original fitment type for ERR4755 and ERR5209G | 1 |
| | STC8368G | CAP, distributor, Genuine May be used to replace RTC3197 | 1 |
| | STC8368L | CAP, distributor, Lucas May be used to replace RTC3197 | 1 |
| 17 | STC1857A | ROTOR ARM | 1 |
| | STC1857G | ROTOR ARM, Genuine | 1 |
| | STC1857L | ROTOR ARM, Lucas | 1 |
| 18 | RTC5090 | BASE PLATE AND PICK UP Through (e) 35D09449B and 36D28463B | 1 |
| | STC2898 | BASE PLATE AND PICK UP From (e) 35D09450B and 36D28464B on | 1 |
| 19 | STC1184 | MODULE, amplifier, 3 pin type | 1 |
| | STC1212G | LINK LEAD, module to harness, 3 pin type, Genuine | 1 |
| | STC1856G | RELOCATION KIT, amplifier module, Genuine From (e) 35D09450B and 36D28464B on | 1 |
| 20 | STC1186G | VACUUM ADVANCE UNIT, 3 pin type, Genuine | 1 |
| 21 | 603446G | O RING, distributor shaft, Genuine | 1 |

ILL. No.	Part No.	Description	Qty. Rqd.
----------	----------	-------------	-----------

Coils

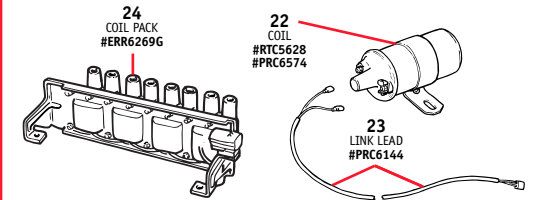

- | | | | |
|----|----------|--|---|
| 22 | RTC5628 | COIL, ignition, Lucas (e) 35D, 36D engines | 1 |
| | PRC6574 | COIL, ignition, Bosch (e) 35D, 36D engines | 1 |
| 23 | PRC6144 | LINK LEAD, ignition coil, Genuine (e) 35D, 36D engines | 1 |
| 24 | ERR6269G | COIL PACK, ignition, Genuine (e) 50D engines | 1 |

25 TUNE UP KIT #9199G #9199E



26 EMERGENCY KIT #9226



- | | | | |
|----|-------|--|---|
| 25 | 9199G | TUNE UP KIT, premium Includes Bosch Platinum plugs and Lucas cap and rotor arm | 1 |
| | 9199E | TUNE UP KIT, standard | 1 |
| 26 | 9226 | EMERGENCY KIT, breakdown Through 1995 model year | 1 |