

ILL. No.	Part No.	Description	Qty. Rqd.
----------	----------	-------------	-----------

MANUAL TRANSMISSION

REMARKS LEGEND -

Vehicle i.d. (v) numbers:
RA = 1994 model year

MONEY-SAVING KITS NOTED IN RED TYPE

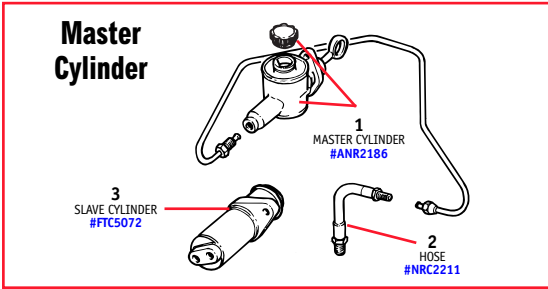

- | | | | |
|---|---------|---|---|
| 1 | ANR2186 | MASTER CYLINDER, clutch | 1 |
| 2 | NRC2211 | HOSE, master cylinder to slave cylinder | 1 |
| 3 | FTC5072 | SLAVE CYLINDER, clutch | 1 |
| <i>The shim plate, if previously fitted, is not required with this new cylinder</i> | | | |
| 4 | STC2818 | REPAIR KIT, slave cylinder | 1 |

5 Clutch Kit #FTC4828

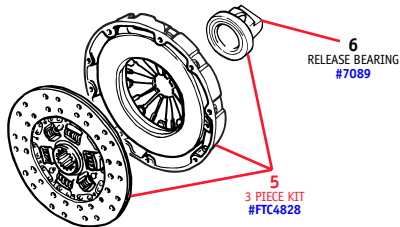

- | | | | |
|---|----------|--|---|
| 5 | FTC4828 | CLUTCH KIT, 3 piece
<i>Includes cover, plate and bearing</i> | 1 |
| 6 | 7089 | RELEASE BEARING, clutch | 1 |
| 7 | STC1543R | TRANSMISSION ASSY, 5-speed manual, remanufactured | 1 |
| 8 | AMR3918 | SWITCH, reverse lamps, R380 5-Speed
<i>From (v) RA109621 on</i> | 1 |



7 TRANSMISSION ASSY
#STC1543R

ILL. No.	Part No.	Description	Qty. Rqd.
----------	----------	-------------	-----------



8 REVERSE SWITCH, R380 5-SPEED
#AMR3918

TECH TIP: Transmission - Maintenance

Each time you do maintenance on your Discovery, be sure to do a quick check of the transmission cooling lines for leakage. These lines are made of steel and corrosion can be a problem. Often it will be seen as seepage on the line or red drops of Dexron on your garage floor that isn't coming from your power steering pump or steering box.

TECH TIP: Excessive Driveshaft Vibration

If you're experiencing excessive vibration when accelerating or under load, the problem is often linked to the rubber coupling or 'donut' at the end of your driveshaft. Atlantic British has a replacement driveshaft and rear universal coupling that eliminates the noisy rubber coupling and the annoying vibration that comes with it. If that vibration goes away the instant you lay off the gas, this is your problem, and our Driveshaft Replacement Kit (Part #9300) is your solution.

ILL. No.	Part No.	Description	Qty. Rqd.
----------	----------	-------------	-----------

PROPELLER SHAFTS

REMARKS LEGEND -

Vehicle i.d. (v) numbers:
VA = 1997 model year



1 GAITER
#276483



2 UNIVERSAL JOINT
#TVC100010



3 COUPLING
#TVF100010G

- | | | | |
|---|------------|---|-----|
| 1 | 276483 | GAITER, front propeller shaft | 1 |
| 2 | TVC100010 | UNIVERSAL JOINT, front and rear propeller shafts | A/R |
| 3 | TVF100010G | RUBBER COUPLING, rear propeller shaft, Genuine
<i>Through (v) VA541627 and VA710668</i> | 1 |
| 4 | 9300 | CONVERSION KIT, rear propeller shaft
<i>Eliminates rubber coupling by using standard universal joint</i> | 1 |
| 5 | FRC8387 | PROPELLER SHAFT ASSEMBLY, rear
<i>From (v) VA541628 and VA710669 on</i> | 1 |



4 CONVERSION KIT
#9300



5 PROP SHAFT ASSEMBLY
#FRC8387