

Ttl. No.	Part No.	Description	Qty. Rqd.
----------	----------	-------------	-----------

INJECTION EQUIPMENT

REMARKS LEGEND -

Engine (e) numbers:

35D = 3.9 liter, manual transmission, distributor ignition

36D = 3.9 liter, automatic transmission, distributor ignition

50D = 4.0 liter, electronic ignition

Vehicle i.d. (v) numbers:

RA = 1994 model year

MONEY-SAVING KITS NOTED IN RED TYPE

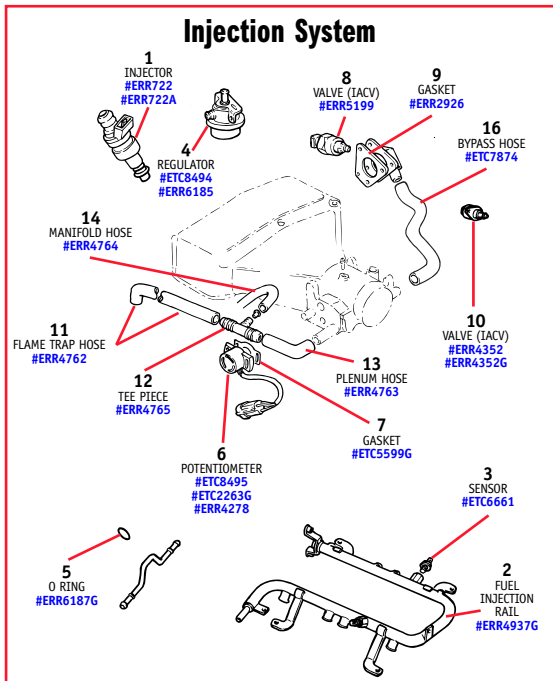

1	ERR722	FUEL INJECTOR	8
	ERR722A	FUEL INJECTOR KIT, set of 8	1
2	ERR4937G	FUEL INJECTION RAIL, non-Bosch, Genuine	1
	ETC6661	SENSOR, fuel temperature	1
4	ETC8494	REGULATOR, fuel pressure	1
	ERR6185	REGULATOR, fuel pressure, Genuine	1
	ERR6185	REGULATOR, fuel pressure, Genuine	1
5	ERR6187G	O RING, fuel return pipe connection, Genuine	2
	ERR6187G	O RING, fuel return pipe connection, Genuine	2
6	ETC8495	POTENTIOMETER, throttle position, round plug type	1
	ETC8495	POTENTIOMETER, throttle position, round plug type	1
	ERR2263G	POTENTIOMETER, throttle position, flat plug type, Genuine	1
	ERR2263G	POTENTIOMETER, throttle position, flat plug type, Genuine	1
	ERR2263G	POTENTIOMETER, throttle position, flat plug type, Genuine	1

Ttl. No.	Part No.	Description	Qty. Rqd.
----------	----------	-------------	-----------

	ERR4278	POTENTIOMETER, throttle position	1
	ERR4278	POTENTIOMETER, throttle position	1
7	ETC5599G	GASKET, potentiometer, Genuine	1
8	ERR5199	VALVE, idle air control (IACV)	1
	ERR5199	VALVE, idle air control (IACV)	1
9	ERR2926	GASKET, IACV housing	1
	ERR2926	GASKET, IACV housing	1
10	ERR4352	VALVE, idle air control	1
	ERR4352	VALVE, idle air control	1
11	ERR4762	HOSE, flame trap to tee piece	1
	ERR4762	HOSE, flame trap to tee piece	1
12	ERR4765	TEE PIECE RESTRICTOR	1
	ERR4765	TEE PIECE RESTRICTOR	1
13	ERR4763	HOSE, tee piece to plenum	1
	ERR4763	HOSE, tee piece to plenum	1
14	ERR4764	HOSE, tee piece to manifold	1
	ERR4764	HOSE, tee piece to manifold	1



15	9205	PCV TUNE UP KIT	1
	9205	PCV TUNE UP KIT	1

TECH TIP: Discovery I - PCV Tune Up

Pop the hood and look for oil leaks around your valve covers periodically. If you see any seepage (discern any discharge?), you probably have excessive carbon build-up in your pcv system that's causing undue pressure on your seals. It's a simple job to replace them and should be done sooner, rather than later.

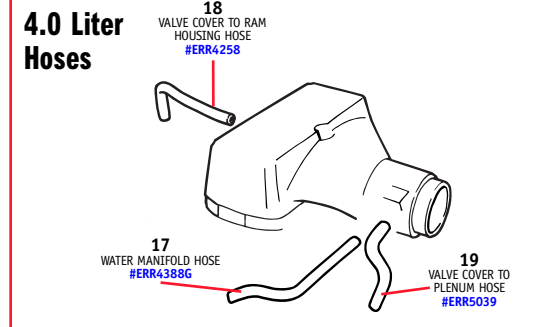

16	ETC7874	HOSE, IACV bypass	1
	ETC7874	HOSE, IACV bypass	1
17	ERR4388G	HOSE, water manifold to plenum, Genuine	1
	ERR4388G	HOSE, water manifold to plenum, Genuine	1
18	ERR4258	HOSE, valve cover to ram housing	1
	ERR4258	HOSE, valve cover to ram housing	1
19	ERR5039	HOSE, valve cover to plenum	1
	ERR5039	HOSE, valve cover to plenum	1

Ttl. No.	Part No.	Description	Qty. Rqd.
----------	----------	-------------	-----------

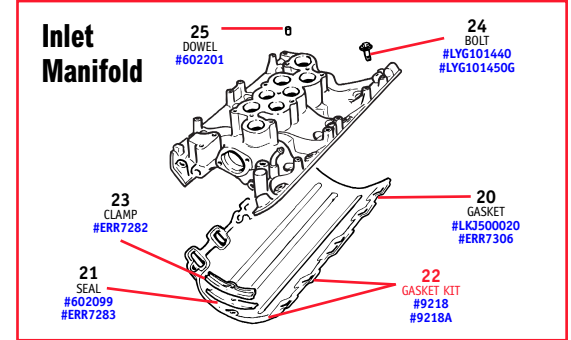

20	LKJ500020	GASKET, intake manifold	1
	LKJ500020	GASKET, intake manifold	1
	ERR7306	GASKET, intake manifold, valley, new style	1
	ERR7306	GASKET, intake manifold, valley, new style	1
21	602099	SEAL, intake manifold gasket	2
	602099	SEAL, intake manifold gasket	2
	ERR7283	SEAL, intake manifold gasket	2
	ERR7283	SEAL, intake manifold gasket	2
22	9218	GASKET KIT, intake manifold	1
	9218	GASKET KIT, intake manifold	1
	9218A	GASKET KIT, intake manifold	1
	9218A	GASKET KIT, intake manifold	1
23	ERR7282	CLAMP, seal	2
	ERR7282	CLAMP, seal	2
24	LYG101440	BOLT, flanged, intake manifold, short	1
	LYG101440	BOLT, flanged, intake manifold, short	1
	LYG101450G	BOLT, flanged, intake manifold, long, Genuine	2
	LYG101450G	BOLT, flanged, intake manifold, long, Genuine	2
25	602201	DOWEL PIN, locating ram housing	2
	602201	DOWEL PIN, locating ram housing	2

TECH TIP: Discovery I 4.0 Know Your Emissions System



If your Discovery I was built in October 1996 or later, it has a specific 'Evaporative Emissions Family' that will help you determine key fuel system replacement parts like oxygen sensors, fuel pump, fuel filler cap, fuel tank and filler pipe assembly, charcoal canister and more. To identify your 'Evap Family,' check your vehicle information label under the hood on the vertical face of the hood latch panel.

VLR1124AYPFE = Advanced Evaporative Loss System
VLR1060AYPBC = Standard Evaporative Loss System
 Know your 'Evap Family' ID when calling to order fuel system parts!