

Timing Components

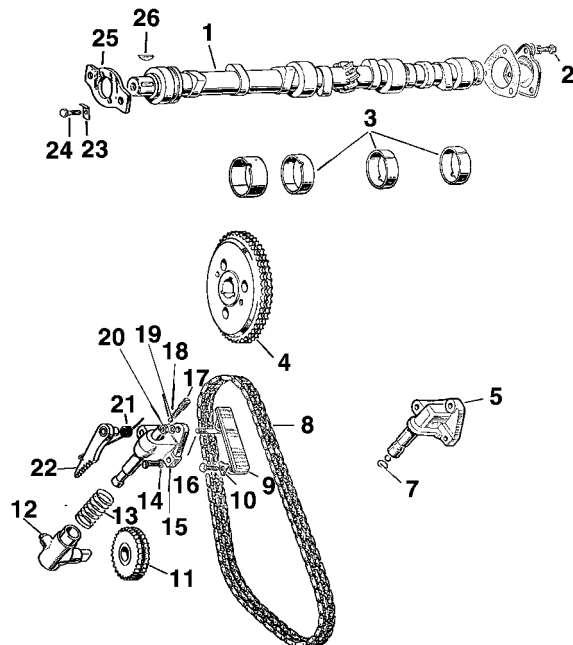

TIMING COMPONENTS, CAMSHAFT

Ref #	Description	Qty	Part #
1	Camshaft 2-1/4 Petrol	1	3760
1	Camshaft 2-1/4 Diesel	1	*NLA 3788
1	Camshaft 2.6 Petrol	1	*NLA 3790
2	Set Bolt 3 1507		
3	Cam Bearing Set 2-1/4 - All (finished)	1	5317
3	Cam Bearing Set 2.6 Petrol	1	6288
3	Cam Bearing Set (53-58)	1	5316
4	Chainwheel for Camshaft	1	6317
5	Piston for Timing Chain to Engine 151017422	1	*NLA 457
7	Retainer for Steel Ball	1	447
8	Timing Chain 2? - all	1	78
8	Timing Chain 2.6 Litre	1	*NLA 9
9	Vibration Damper - all	1	6411
10	Locking Plate	2	3763
11	Idler Gear	1	6318
12	Cylinder for Adjuster	1	3507
13	Spring for Tensioner	1	6320
14	Spring Washer	2	5690
15	Piston for Adjuster (later style)	1	6412
16	Stud	1	*NLA 1469
17	Plug for Retainer	1	446
18	Spring Retainer	1	447
19	Steel Ball	1	454
20	Nut	1	1436
21	Spring, Adjuster Ratchet	1	6319
22	Ratchet	1	3077
23	Locker, Thrust Plate	2	3762
24	Set Bolt 2	1	508
25	Thrust Plate	1	3761
26	Key, Chainwheel	1	3759

*NLA = No longer available.

Ref #	Description	Qty	Part #
not shown	Timing Pointer, Front Pulley	1	6316
not shown	Tension Assembly 2.6 only	1	3077
not shown	Crankshaft Chainwheel	1	3601
not shown	Key, Crankshaft Chainwheel	1	5156
→	TIMING CHAIN RENEW KIT	KIT	3819
	Includes:		
	1 - Cam Chainwheel, 1 - Crank Chainwheel, 1 - Idler Gear,		
	1 - Ratchet Spring, 1 - Tensioner Spring,		
	1 - Vibration Damper, 1 - Ratchet, 1 - Timing Chain,		
	1 - Tensioner Cylinder		
→	CAMSHAFT OVERHAUL KIT	KIT	3820
	Includes:		
	1 - #5317 Cam Bearing Set, 2-1/4 finished,		
	8 - #1916 Tappet Assembly		

Some items in this section may be available on a special order basis or phone-order only. Please call for pricing and availability.