

ILL. No.	Part No.	Description	Qty. Rqd.
----------	----------	-------------	-----------

## FUEL SYSTEM

### MONEY-SAVING KITS NOTED IN RED TYPE



**3**  
FUEL PUMP  
#ESR3926  
#WFX101020

### Fuel Tank Assembly

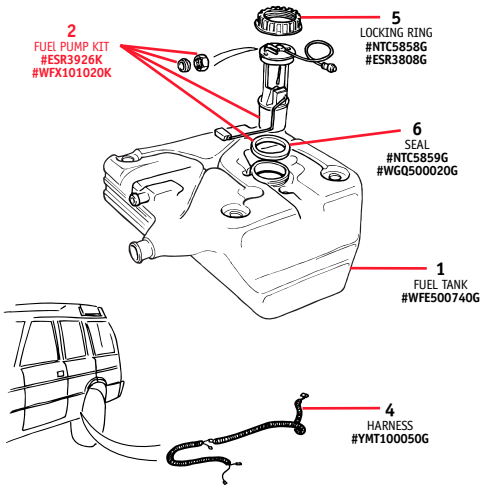

- |   |                        |   |   |
|---|------------------------|---|---|
| 1 | WFE500740G             | FUEL TANK ASSEMBLY, Genuine<br><i>Not advanced evaporative loss models</i>  | 1 |
| 2 | ESR3926K<br>WFX101020K | KIT, fuel pump & sender unit<br><i>Not advanced evaporative loss models;</i><br><i>includes pump, sealing ring, pipe nuts &amp; olives</i><br>KIT, fuel pump & sender unit, plus seal,<br><i>Advanced evaporative loss models</i> | 1 |
| 3 | ESR3926<br>WFX101020   | FUEL PUMP AND SENDER UNIT<br><i>Not advanced evaporative loss models</i><br>FUEL PUMP AND SENDER UNIT<br><i>Advanced evaporative loss models</i>  | 1 |
| 4 | YMT100050G             | HARNESSES, fuel pump & sender unit, Genuine<br><i>Advanced evaporative loss models</i>  | 1 |
| 5 | NTC5858G<br>ESR3808G   | LOCKING RING, fuel pump to tank, Genuine<br><i>Not advanced evaporative loss models</i><br>LOCKING RING, fuel pump to tank, Genuine<br><i>Advanced evaporative loss models</i>  | 1 |
| 6 | NTC5859G<br>WGQ500020G | SEAL, fuel pump to tank, Genuine<br><i>Not advanced evaporative loss models</i><br>SEAL, fuel pump to tank, Genuine<br><i>Advanced evaporative loss models</i>  | 1 |

ILL. No.	Part No.	Description	Qty. Rqd.
----------	----------	-------------	-----------

### Fuel Filler

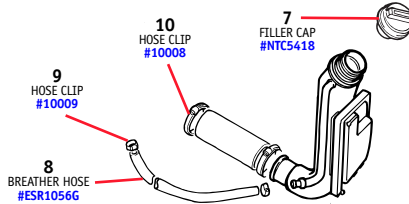

- |    |          |  |     |
|----|----------|--|-----|
| 7  | NTC5418  | CAP, fuel filler<br><i>Not advanced evaporative loss models</i>                          | 1   |
| 8  | ESR1056G | HOSE, fuel tank breather, Genuine<br><i>Not advanced evaporative loss models</i>         | 1   |
| 9  | 10009    | HOSE CLIP, 1/2 inch dia., stainless steel<br><i>Not advanced evaporative loss models</i> | A/R |
| 10 | 10008    | HOSE CLIP, 3 inch dia., stainless steel<br><i>Not advanced evaporative loss models</i>   | A/R |

### Fuel Filter and Lines

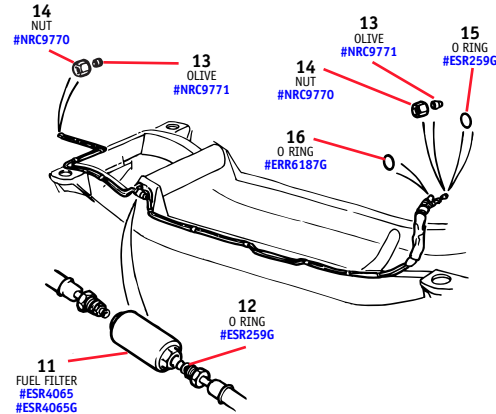

- |    |                     |   |   |
|----|---------------------|---|---|
| 11 | ESR4065<br>ESR4065G | FILTER, fuel<br>FILTER, fuel, Genuine   | 1 |
| 12 | ESR259G             | O RING, filter union, Genuine   | 2 |
| 13 | NRC9771             | OLIVE, feed pipe to tank and engine,<br><i>Not advanced evaporative loss models</i> | 2 |
| 14 | NRC9770             | NUT, feed pipe to tank and engine,<br><i>Not advanced evaporative loss models</i>   | 2 |
| 15 | ESR259G             | O RING, feed pipe to engine, Genuine<br><i>Advanced evaporative loss models</i>     | 1 |
| 16 | ERR6187G            | O RING, return pipe to engine, Genuine<br><i>Advanced evaporative loss models</i>   | 1 |



**11**  
FUEL FILTER  
#ESR4065  
#ESR4065G

ILL. No.	Part No.	Description	Qty. Rqd.
----------	----------	-------------	-----------

## AIR FILTERS

### REMARKS LEGEND -

Engine (e) numbers  
35D = 3.9 liter, manual transmission,  
distributor ignition  
36D = 3.9 liter, automatic transmission,  
distributor ignition  
50D = 4.0 liter, electronic ignition  
Vehicle i.d. (v) numbers:  
RA = 1994 model year;  
VA = 1997 model year

### MONEY-SAVING KITS NOTED IN RED TYPE

### Air Filter Assembly

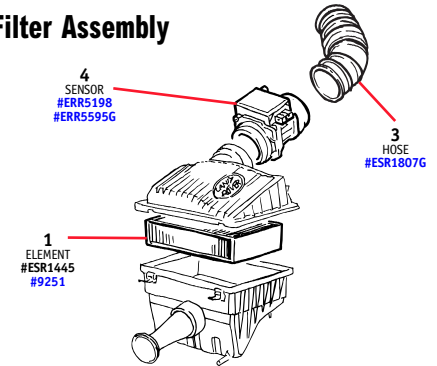

- |   |                     |  |   |
|---|---------------------|--|---|
| 1 | ESR1445<br>9251     | AIR FILTER ELEMENT, standard type<br>AIR FILTER ELEMENT, K&N premium                       | 1 |
| 2 | 9244                | SERVICE KIT, K&N air filter<br><i>Includes air filter cleaner and oil</i>                  | 1 |
| 3 | ESR1807G            | HOSE, air intake, Genuine  | 1 |
| 4 | ERR5198<br>ERR5959G | SENSOR, mass air flow<br>(e) 35D, 36D<br>SENSOR, mass air flow, Genuine<br>(e) 50D engines | 1 |

### K & N Air Filter

*The last air filter you'll ever have to buy!* This high-flow air filter will help your engine breathe better so it can perform better. A special multi-cotton fabric acts as an atomizer to eliminate the harsh effects of rain, dirt, grime, dust and smoke. After 30-40,000 miles you simply take it out, clean it, re-oil it and put it back—no replacement necessary!

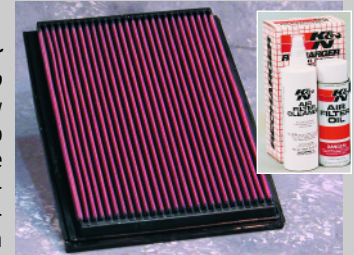

Discovery I - K & N Filter (9251)

K & N Service/Cleaner Kit (9244)

Ttl. No.	Part No.	Description	Qty. Rqd.
----------	----------	-------------	-----------

## INJECTION EQUIPMENT

### REMARKS LEGEND -

#### Engine (e) numbers:

35D = 3.9 liter, manual transmission, distributor ignition

36D = 3.9 liter, automatic transmission, distributor ignition

50D = 4.0 liter, electronic ignition

#### Vehicle i.d. (v) numbers:

RA = 1994 model year

### MONEY-SAVING KITS NOTED IN RED TYPE

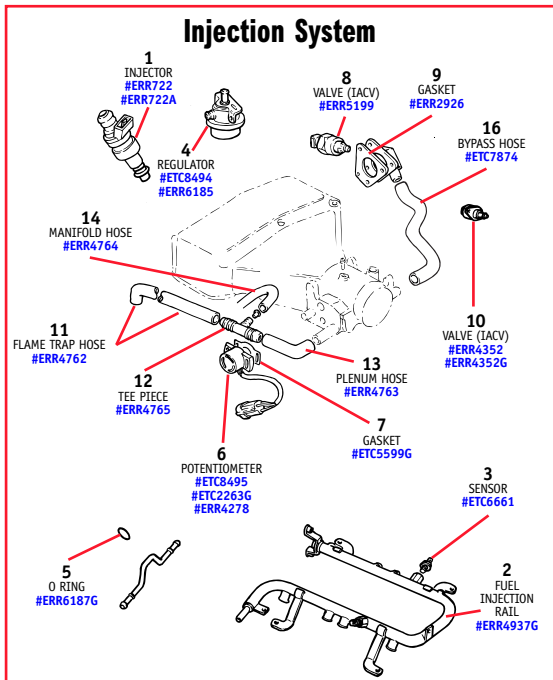

1	ERR722	FUEL INJECTOR	8
	ERR722A	FUEL INJECTOR KIT, set of 8	1
2	ERR4937G	FUEL INJECTION RAIL, non-Bosch, Genuine	1
	ETC6661	SENSOR, fuel temperature	1
4	ETC8494	REGULATOR, fuel pressure	1
	ERR6185	REGULATOR, fuel pressure, Genuine	1
	ERR6185	Not advanced evaporative loss models	
	ERR6185	Advanced evaporative loss models	
5	ERR6187G	O RING, fuel return pipe connection, Genuine	2
	ERR6187G	Advanced evaporative loss models	
6	ETC8495	POTENTIOMETER, throttle position, round plug type	1
	ETC8495	(e) 35D, 36D up to (v) RA112194	
	ERR2263G	POTENTIOMETER, throttle position, flat plug type, Genuine	1
	ERR2263G	(e) 35D, 36D from (v) RA112195 on	

Ttl. No.	Part No.	Description	Qty. Rqd.
----------	----------	-------------	-----------

	ERR4278	POTENTIOMETER, throttle position	1
	ERR4278	(e) 50D engines	
7	ETC5599G	GASKET, potentiometer, Genuine	1
8	ERR5199	VALVE, idle air control (IACV)	1
	ERR5199	(e) 35D, 36D engines	
9	ERR2926	GASKET, IACV housing	1
	ERR2926	(e) 35D, 36D engines	
10	ERR4352	VALVE, idle air control	1
	ERR4352	(e) 50D engines	
11	ERR4762	HOSE, flame trap to tee piece	1
	ERR4762	(e) 35D, 36D engines	
12	ERR4765	TEE PIECE RESTRICTOR	1
	ERR4765	(e) 35D, 36D engines	
13	ERR4763	HOSE, tee piece to plenum	1
	ERR4763	(e) 35D, 36D engines	
14	ERR4764	HOSE, tee piece to manifold	1
	ERR4764	(e) 35D, 36D engines	



15	9205	PCV TUNE UP KIT	1
	9205	(e) 35D, 36D engines; includes items 11 - 14	

### TECH TIP: Discovery I - PCV Tune Up

Pop the hood and look for oil leaks around your valve covers periodically. If you see any seepage (discern any discharge?), you probably have excessive carbon build-up in your pcv system that's causing undue pressure on your seals. It's a simple job to replace them and should be done sooner, rather than later.

### 4.0 Liter Hoses

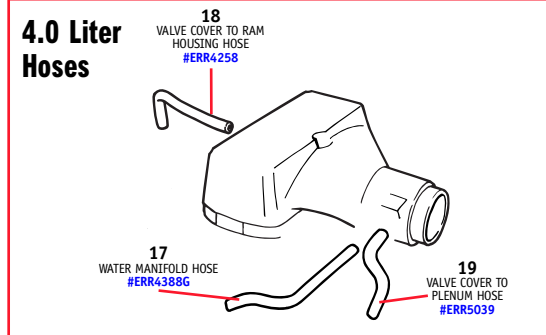

16	ETC7874	HOSE, IACV bypass	1
	ETC7874	(e) 35D, 36D engines	
17	ERR4388G	HOSE, water manifold to plenum, Genuine	1
	ERR4388G	(e) 50D engines	
18	ERR4258	HOSE, valve cover to ram housing	1
	ERR4258	(e) 50D engines	
19	ERR5039	HOSE, valve cover to plenum	1
	ERR5039	(e) 50D engines	

Ttl. No.	Part No.	Description	Qty. Rqd.
----------	----------	-------------	-----------

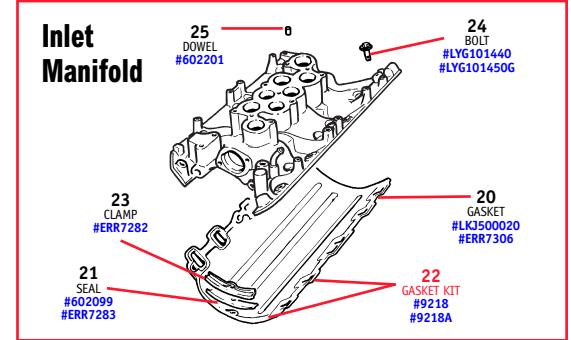

20	LKJ500020	GASKET, intake manifold	1
	LKJ500020	(e) 35D, 36D; (e) 50D through (v) VA558699	
	ERR7306	GASKET, intake manifold, valley, new style	1
	ERR7306	(e) 50D from (v) VA558700 on	
21	602099	SEAL, intake manifold gasket	2
	602099	(e) 35D, 36D; through (e) 50D36201A	
	ERR7283	SEAL, intake manifold gasket	2
	ERR7283	From (e) 50D36202A on	
22	9218	GASKET KIT, intake manifold	1
	9218	(e) 35D, 36D; (e) 50D through (v) VA558699	
	9218A	GASKET KIT, intake manifold	1
	9218A	(e) 50D from (v) VA558700 on	
23	ERR7282	CLAMP, seal	2
	ERR7282	From (e) 50D36202A on	
24	LYG101440	BOLT, flanged, intake manifold, short	1
	LYG101440	Replaces earlier bolt and washer	
	LYG101450G	BOLT, flanged, intake manifold, long, Genuine	2
	LYG101450G	Replaces earlier bolt and washer	
25	602201	DOWEL PIN, locating ram housing	2
	602201	(e) 35D, 36D engines	
	602201	Not flanged type	

### TECH TIP: Discovery I 4.0 Know Your Emissions System



If your Discovery I was built in October 1996 or later, it has a specific 'Evaporative Emissions Family' that will help you determine key fuel system replacement parts like oxygen sensors, fuel pump, fuel filler cap, fuel tank and filler pipe assembly, charcoal canister and more. To identify your 'Evap Family,' check your vehicle information label under the hood on the vertical face of the hood latch panel.

VLR1124AYPFE = Advanced Evaporative Loss System

VLR1060AYPBC = Standard Evaporative Loss System

Know your 'Evap Family' ID when calling to order fuel system parts!



TO ORDER, CALL **1-800-533-2210**